

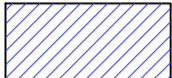

LEGEND	
	NEW AREA ADDED
	INTERNAL CHANGE AREA
	SANCTION AREA NOT CONSTRUCTED



- NOTES:
- ALL LIFTS SHALL HAVE 100% POWER BACK-UP.
 - ALL ELECTRICAL INSTALLATIONS SHALL BE AS PER PROVISION OF NBC.
 - FIRE RESISTANT JARITY PROVISIONS WILL BE AS PER RELEVANT NBC PROVISIONS.
 - BASEMENT AREA SHALL HAVE MECHANICALLY VENTILATED AS PER RELEVANT CODE.
 - ALL TOILETS ARE VENTILATED AS PER NATIONAL BUILDING CODE 2017.
 - BUILDING HAS AUTOMATIC SPRINKLER SYSTEM WHEREVER REQUIRED BY NBC.
 - BUILDING WILL BE DESIGNATED STRUCTURES AS PER RELEVANT I.S. CODES FOR EARTHQUAKE RESISTANCE.
 - THE RESPONSIBILITY OF STRUCTURE DESIGN AND STRUCTURE STABILITY OF BUILDING AGAINST THE EARTHQUAKE SHALL BE ENTIRELY OF THE STRUCTURE ENGINEER/ ARCHITECT/ENGINEER.
 - THE RAIN WATER HARVESTING SYSTEM SHALL BE PROVIDED AS PER CENTRAL GROUND WATER AUTHORITY NORMS.
 - SOLAR PANELS OF REQUIRED CAPACITY SHALL BE PROVIDED ON ROOF TOP AS PER THE COLLECTOR/OWNER SHALL USE ONLY LIGHT EMITTING DIODE (LAMP) FITTING FOR INTERNAL LIGHTING AS WELL AS CAMPUS LIGHTING.
 - ALL HANDICAP RAMPS WITH RAILING.

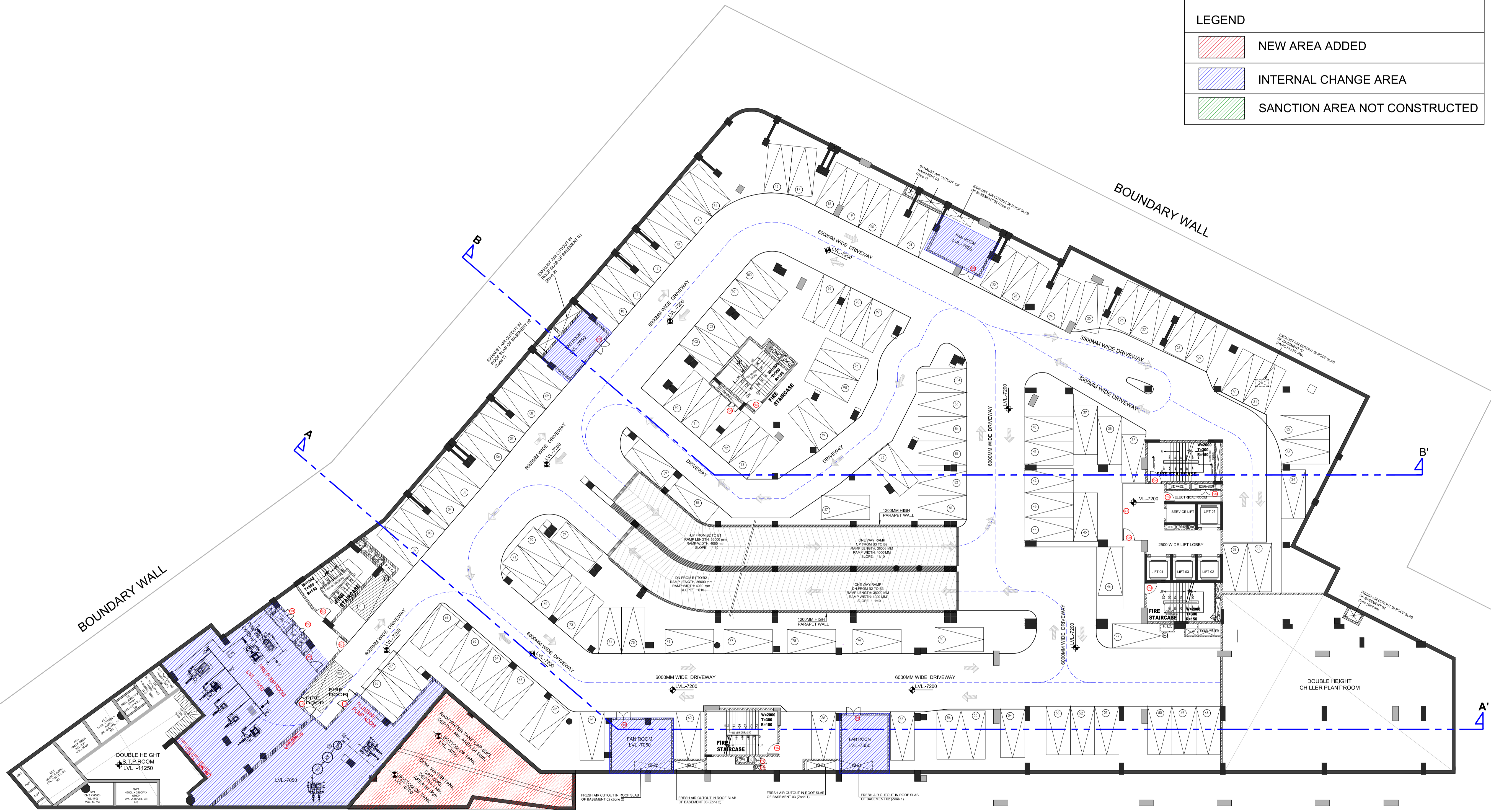
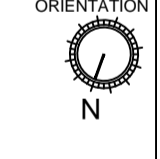

PRINCIPAL ARCHITECT:

ACPL 150 9001 2008
 Architecture
 Management
 Planning

ACPL Design Ltd. E-24, South Extension - II, 1st Flr, 1st Stage, New Delhi 110048, India. +91 11 26467019
 www.acplindia.com C: contact@acplindia.com P: 081 11 26467019

PROJECT:-
 REVISED BUILDING PLANS FOR
 IN COMMERCIAL COLONY MEASURING 2.71875 Acres
 (LICENCE NO. 72 OF 2013 DATED 27-07-2013)
 IN SECTOR-82, GURGAON MANESAR URBAN COMPLEX
 BEING DEVELOPED BY M's SPAZE TOWERS PVT.LTD.

OWNER/AUTH. SIGNATURE	ARCHITECT'S SIGNATURE
DRAWING TITLE	
SECOND BASEMENT PLAN	
DRAWING NO. 03	SCALE - 1:200