

LEGEND	
	NEW AREA ADDED
	INTERNAL CHANGE AREA
	SANCTION AREA NOT CONSTRUCTED

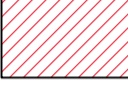

- NOTES:**
- ALL LIFTS SHALL HAVE 100% POWER BACK UP.
 - ALL ELECTRICAL INSTALLATIONS SHALL BE AS PER PROVISION OF NBC.
 - FIRE FIGHTING APARTY PROVISIONS SHALL BE AS PER RELEVANT NBC. PROVISIONS, BASEMENT AREA SHALL HAVE MECHANICALLY VENTILATED AS PER RELEVANT CODE.
 - ALL TOILETS ARE VENTILATED AS PER NATIONAL BUILDING CODE 2017.
 - BUILDING HAS AUTOMATIC SPRINKLER SYSTEM WHEREVER REQUIRED BY NBC.
 - BUILDING WILL BE DESIGNED STRUCTURES AS PER RELEVANT I.S. CODES FOR EARTHQUAKE RESISTANCE.
 - THE RESPONSIBILITY OF STRUCTURE DESIGN AND STRUCTURE STABILITY OF BUILDING AGAINST THE EARTHQUAKE SHALL BE ENTIRELY OF THE STRUCTURE ENGINEER/ ARCHITECT/OWNER.
 - THE RAIN WATER HARVESTING SYSTEM SHALL BE PROVIDED AS PER CENTRAL GROUND WATER AUTHORITY NORMS.
 - SOLAR PANELS OF REQUIRED CAPACITY SHALL BE PROVIDED ON ROOF TOP AS PER THE COLLECTOR OWNER SHALL USE ONLY EIGHT SANITING TOOLS (HANDLES) FITTING FOR INTERNAL LIGHTING AS WELL AS CAMPUS LIGHTING.
 - ALL HANDICAP RAMP WITH RAILING.

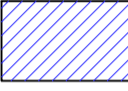
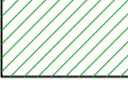
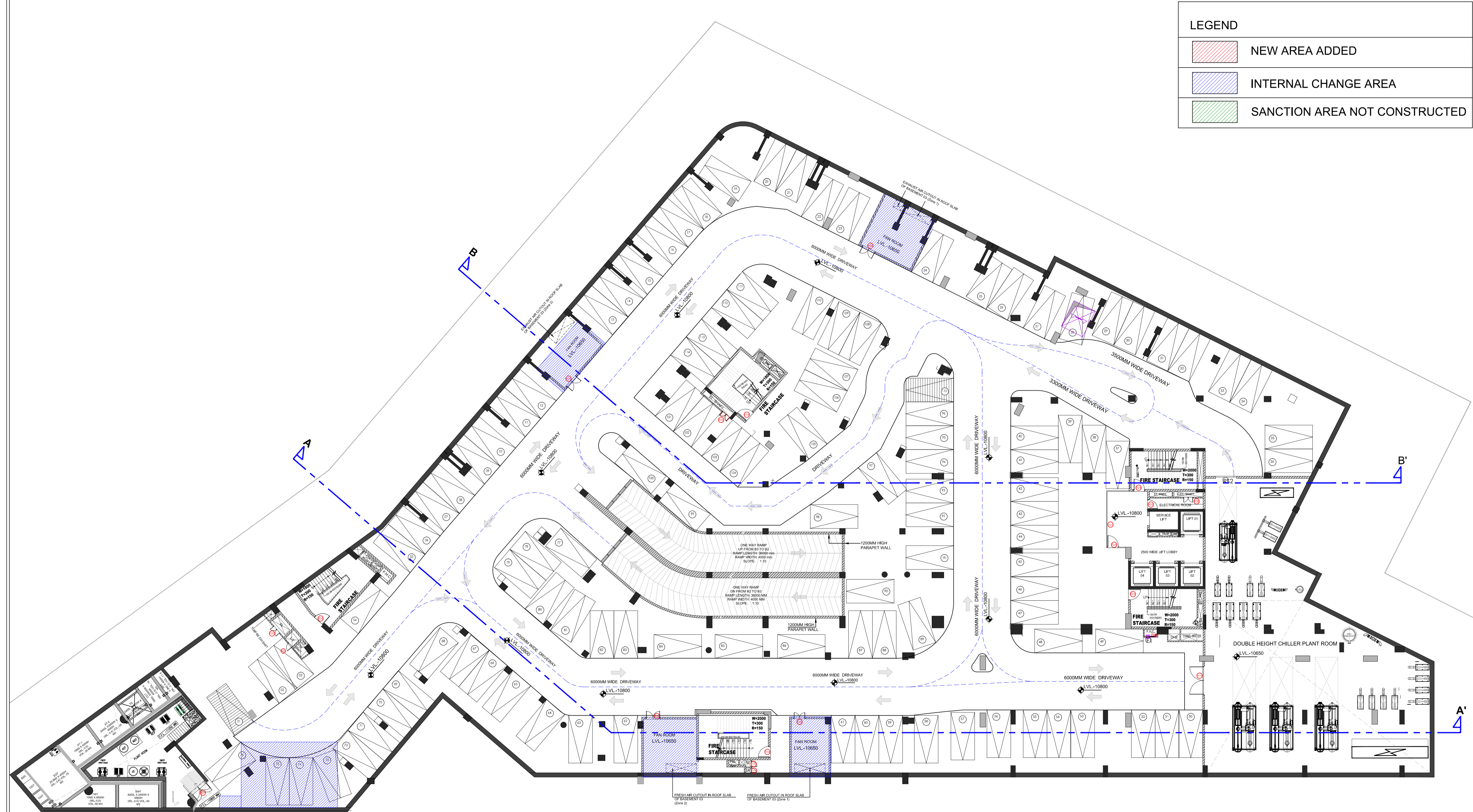
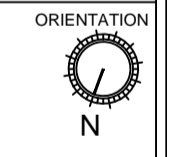

PRINCIPAL ARCHITECT:

ACPL ISO 9001:2008
 Architecture
 Management
 Planning

ACPL Design Ltd. 2-28, South Gardenia, 11, 4th Fl, 4422105
 New Delhi 110048, India. +91 11 2444709
 www.acplindia.com C: contact@acplindia.com Ph: 448 11 2444709

PROJECT:-
 REVISED BUILDING PLANS FOR
 IN COMMERCIAL COLONY MEASURING 2.71875 Acres
 (LICENCE NO. 72 OF 2013 DATED 27-07-2013)
 IN SECTOR-92, GURGAON MANESAR URBAN COMPLEX
 BEING DEVELOPED BY M/s SPAZE TOWERS PVT.LTD.

OWNER/AUTH. SIGNATURE	ARCHITECT'S SIGNATURE
DRAWING TITLE	
THIRD BASEMENT PLAN	
DRAWING NO. 04	SCALE - 1:200